

T. Barrett & Associates
Address: PO Box 5069
Louisville, KY 40255
Phone: 502.365.1462
Fax: 502.290.2091
Toll Free: 1-877-770-1113

Insured: Winchester Lake Apartments LLC
Property: 5670-5698 Gatling Drive
Canal Winchester, OH 43110

Business: (614) 317-1781

Claim Rep.: Bob Greaser
Company: T. Barrett and Associates

Business: (317) 522-6757
E-mail: bobgreaser@yahoo.com

Estimator: Bob Greaser
Company: T. Barrett and Associates

Business: (317) 522-6757
E-mail: bobgreaser@yahoo.com

Claim Number: 2BDH3

Policy Number: HEICP-250163

Type of Loss: Wind Damage

Date Contacted: 5/1/2024 6:24 PM

Date of Loss: 3/14/2024 6:31 PM

Date Received: 5/1/2024 6:32 PM

Date Inspected: 5/17/2024 6:32 PM

Date Entered: 5/17/2024 6:29 PM

Price List: OHCO8X_MAY24
Restoration/Service/Remodel

Estimate: 2BDH3_WIND_LAKE-B1

This estimate of repair contains our repair recommendations, subject to review by the insurance company. No adjuster has authority to authorize repairs or guarantee payment.

Any person who knowingly and with intent to defraud any insurance company or another person, files a statement of claim containing any materially false information, or conceals for the purpose of misleading, information concerning any fact, material thereto, commits a fraudulent insurance act, which is a crime, subject to criminal prosecution.

T. Barrett & Associates
 Address: PO Box 5069
 Louisville, KY 40255
 Phone: 502.365.1462
 Fax: 502.290.2091
 Toll Free: 1-877-770-1113

2BDH3_WIND_LAKE-B1
BLDG 1 - 5670-5698 Gatling
Exterior

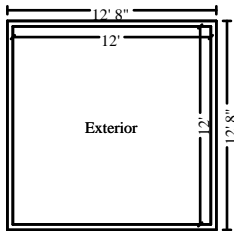

Exterior

Height: 8'

384.00 SF Walls	144.00 SF Ceiling
528.00 SF Walls & Ceiling	144.00 SF Floor
16.00 SY Flooring	48.00 LF Floor Perimeter
48.00 LF Ceil. Perimeter	

DESCRIPTION

QTY

237. Siding - Labor Minimum	1.00 EA
-----------------------------	---------

NOTES:

Roof



Roof BLDG 1

7376.96 Surface Area	73.77 Number of Squares
664.82 Total Perimeter Length	208.42 Total Ridge Length

DESCRIPTION

QTY

221. Remove Laminated - comp. shingle rfg. - w/out felt	73.77 SQ
223. Laminated - comp. shingle rfg. - w/out felt	81.33 SQ
224. Roofing felt - 15 lb.	56.54 SQ
225. Ice & water barrier	1723.44 SF
In valleys.	

T. Barrett & Associates
 Address: PO Box 5069
 Louisville, KY 40255
 Phone: 502.365.1462
 Fax: 502.290.2091
 Toll Free: 1-877-770-1113

CONTINUED - Roof BLDG 1

DESCRIPTION	QTY
226. R&R Valley metal - (W) profile - painted	109.31 LF
227. R&R Drip edge	664.82 LF
228. Asphalt starter - universal starter course	465.17 LF
229. Continuous ridge vent - shingle-over style	180.00 LF
230. Hip / Ridge cap - Standard profile - composition shingles	208.42 LF
231. Flashing - pipe jack	24.00 EA
232. Roof vent - turtle type - Metal	16.00 EA
233. Remove Additional charge for high roof (2 stories or greater)	73.77 SQ
234. Additional charge for high roof (2 stories or greater)	73.77 SQ
235. Remove Additional charge for steep roof - 10/12 - 12/12 slope	73.77 SQ
236. Additional charge for steep roof - 10/12 - 12/12 slope	73.77 SQ

NOTES:

Grand Total Areas:

384.00 SF Walls	144.00 SF Ceiling	528.00 SF Walls and Ceiling
144.00 SF Floor	16.00 SY Flooring	48.00 LF Floor Perimeter
0.00 SF Long Wall	0.00 SF Short Wall	48.00 LF Ceil. Perimeter
144.00 Floor Area	160.44 Total Area	384.00 Interior Wall Area
2,376.03 Exterior Wall Area	50.67 Exterior Perimeter of Walls	
7,376.96 Surface Area	73.77 Number of Squares	664.82 Total Perimeter Length
208.42 Total Ridge Length	0.00 Total Hip Length	

T. Barrett & Associates
Address: PO Box 5069
Louisville, KY 40255
Phone: 502.365.1462
Fax: 502.290.2091
Toll Free: 1-877-770-1113

Insured: Winchester Lake Apartments LLC
Property: 6655 Kodiak Drive
Canal Winchester, OH 43110

Business: (614) 317-1781

Claim Rep.: Bob Greaser
Company: T. Barrett and Associates

Business: (317) 522-6757
E-mail: bobgreaser@yahoo.com

Estimator: Bob Greaser
Company: T. Barrett and Associates

Business: (317) 522-6757
E-mail: bobgreaser@yahoo.com

Claim Number: 2BDH3

Policy Number: HEICP-250163

Type of Loss: Wind Damage

Date Contacted: 5/1/2024 7:04 PM

Date of Loss: 3/14/2024 6:31 PM

Date Received: 5/1/2024 6:32 PM

Date Inspected: 5/17/2024 6:32 PM

Date Entered: 5/17/2024 6:29 PM

Price List: OHCO8X_MAY24
Restoration/Service/Remodel
Estimate: 2BDH3_WINDCHES_BLD20

This estimate of repair contains our repair recommendations, subject to review by the insurance company. No adjuster has authority to authorize repairs or guarantee payment.

Any person who knowingly and with intent to defraud any insurance company or another person, files a statement of claim containing any materially false information, or conceals for the purpose of misleading, information concerning any fact, material thereto, commits a fraudulent insurance act, which is a crime, subject to criminal prosecution.

T. Barrett & Associates
 Address: PO Box 5069
 Louisville, KY 40255
 Phone: 502.365.1462
 Fax: 502.290.2091
 Toll Free: 1-877-770-1113

2BDH3_WINDCHES_BLD20

BLDG 20 6655 Kodiak Drive

Roof

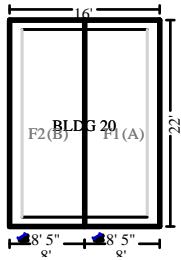

BLDG 20

371.04	Surface Area	3.71	Number of Squares
77.73	Total Perimeter Length	22.00	Total Ridge Length

DESCRIPTION

QTY

NO DAMAGE OBSERVED

NOTES:

Grand Total Areas:

384.00	SF Walls	144.00	SF Ceiling	528.00	SF Walls and Ceiling
144.00	SF Floor	16.00	SY Flooring	48.00	LF Floor Perimeter
0.00	SF Long Wall	0.00	SF Short Wall	48.00	LF Ceil. Perimeter
144.00	Floor Area	160.44	Total Area	384.00	Interior Wall Area
485.63	Exterior Wall Area	50.67	Exterior Perimeter of Walls		
371.04	Surface Area	3.71	Number of Squares	77.73	Total Perimeter Length
22.00	Total Ridge Length	0.00	Total Hip Length		

T. Barrett & Associates
Address: PO Box 5069
Louisville, KY 40255
Phone: 502.365.1462
Fax: 502.290.2091
Toll Free: 1-877-770-1113

Insured: Winchester Lake Apartments LLC
Property: 6600-6628 Kodiak Drive
Canal Winchester, OH 43110

Business: (614) 317-1781

Claim Rep.: Bob Greaser
Company: T. Barrett and Associates

Business: (317) 522-6757
E-mail: bobgreaser@yahoo.com

Estimator: Bob Greaser
Company: T. Barrett and Associates

Business: (317) 522-6757
E-mail: bobgreaser@yahoo.com

Claim Number: 2BDH3

Policy Number: HEICP-250163

Type of Loss: Wind Damage

Date Contacted: 5/1/2024 11:07 PM

Date of Loss: 3/14/2024 6:31 PM

Date Received: 5/1/2024 6:32 PM

Date Inspected: 5/17/2024 6:32 PM

Date Entered: 5/17/2024 6:29 PM

Date Est. Completed: 7/15/2024 6:46 PM

Price List: OHCO8X_MAY24
Restoration/Service/Remodel

Estimate: 2BDH3_WIND_LAKE-B19

This estimate of repair contains our repair recommendations, subject to review by the insurance company. No adjuster has authority to authorize repairs or guarantee payment.

Any person who knowingly and with intent to defraud any insurance company or another person, files a statement of claim containing any materially false information, or conceals for the purpose of misleading, information concerning any fact, material thereto, commits a fraudulent insurance act, which is a crime, subject to criminal prosecution.

T. Barrett & Associates
 Address: PO Box 5069
 Louisville, KY 40255
 Phone: 502.365.1462
 Fax: 502.290.2091
 Toll Free: 1-877-770-1113

CONTINUED - Roof BLDG 19

DESCRIPTION	QTY
In valleys.	
6. Roof vent - turtle type - Metal	16.00 EA
7. R&R Valley metal - (W) profile - painted	63.69 LF
8. R&R Drip edge	537.99 LF
9. Asphalt starter - universal starter course	298.83 LF
10. Continuous ridge vent - shingle-over style	120.08 LF
11. Hip / Ridge cap - Standard profile - composition shingles	140.08 LF
12. Flashing - pipe jack	24.00 EA
13. Remove Additional charge for high roof (2 stories or greater)	48.75 SQ
14. Additional charge for high roof (2 stories or greater)	48.75 SQ
15. Remove Additional charge for steep roof - 10/12 - 12/12 slope	2.39 SQ
16. Additional charge for steep roof - 10/12 - 12/12 slope	2.39 SQ

NOTES:

Grand Total Areas:

384.00 SF Walls	144.00 SF Ceiling	528.00 SF Walls and Ceiling
144.00 SF Floor	16.00 SY Flooring	48.00 LF Floor Perimeter
0.00 SF Long Wall	0.00 SF Short Wall	48.00 LF Ceil. Perimeter
144.00 Floor Area	160.44 Total Area	384.00 Interior Wall Area
3,535.63 Exterior Wall Area	50.67 Exterior Perimeter of Walls	
5,248.63 Surface Area	52.49 Number of Squares	537.99 Total Perimeter Length
140.08 Total Ridge Length	0.00 Total Hip Length	

T. Barrett & Associates
Address: PO Box 5069
Louisville, KY 40255
Phone: 502.365.1462
Fax: 502.290.2091
Toll Free: 1-877-770-1113

Insured: Winchester Lake Apartments LLC
Property: 5601 -5629 Xebec Drive
Canal Winchester, OH 43110

Business: (614) 317-1781

Claim Rep.: Bob Greaser
Company: T. Barrett and Associates

Business: (317) 522-6757
E-mail: bobgreaser@yahoo.com

Estimator: Bob Greaser
Company: T. Barrett and Associates

Business: (317) 522-6757
E-mail: bobgreaser@yahoo.com

Claim Number: 2BDH3

Policy Number: HEICP-250163

Type of Loss: Wind Damage

Date Contacted: 5/1/2024 9:16 PM

Date of Loss: 3/14/2024 6:31 PM

Date Received: 5/1/2024 6:32 PM

Date Inspected: 5/17/2024 6:32 PM

Date Entered: 5/17/2024 6:29 PM

Price List: OHCO8X_MAY24
Restoration/Service/Remodel

Estimate: 2BDH3_WINDCHES_BL18

This estimate of repair contains our repair recommendations, subject to review by the insurance company. No adjuster has authority to authorize repairs or guarantee payment.

Any person who knowingly and with intent to defraud any insurance company or another person, files a statement of claim containing any materially false information, or conceals for the purpose of misleading, information concerning any fact, material thereto, commits a fraudulent insurance act, which is a crime, subject to criminal prosecution.

T. Barrett & Associates
 Address: PO Box 5069
 Louisville, KY 40255
 Phone: 502.365.1462
 Fax: 502.290.2091
 Toll Free: 1-877-770-1113

2BDH3_WINDCHES_BL18
BLDG 18 - 5601-5629 Xebec Drive
Main Level

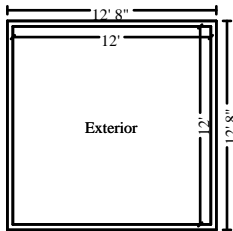

Exterior

Height: 8'

384.00 SF Walls	144.00 SF Ceiling
528.00 SF Walls & Ceiling	144.00 SF Floor
16.00 SY Flooring	48.00 LF Floor Perimeter
48.00 LF Ceil. Perimeter	

DESCRIPTION

QTY

1. Siding - Labor Minimum	1.00 EA
---------------------------	---------

NOTES:

Roof

Roof 18



6437.13 Surface Area	64.37 Number of Squares
577.82 Total Perimeter Length	180.75 Total Ridge Length

DESCRIPTION

QTY

2. Remove Laminated - comp. shingle rfg. - w/out felt	64.37 SQ
3. Laminated - comp. shingle rfg. - w/out felt	71.00 SQ
4. Roofing felt - 15 lb.	47.14 SQ
5. Ice & water barrier	1550.03 SF
In valleys.	

T. Barrett & Associates
 Address: PO Box 5069
 Louisville, KY 40255
 Phone: 502.365.1462
 Fax: 502.290.2091
 Toll Free: 1-877-770-1113

CONTINUED - Roof 18

DESCRIPTION	QTY
6. R&R Valley metal - (W) profile - painted	108.59 LF
7. R&R Drip edge	577.82 LF
8. Asphalt starter - universal starter course	408.08 LF
9. Continuous ridge vent - shingle-over style	160.75 LF
10. Hip / Ridge cap - Standard profile - composition shingles	180.75 LF
11. Flashing - pipe jack	24.00 EA
12. Roof vent - turtle type - Metal	16.00 EA
13. Remove Additional charge for high roof (2 stories or greater)	54.40 SQ
14. Additional charge for high roof (2 stories or greater)	54.40 SQ
15. Remove Additional charge for steep roof - 7/12 to 9/12 slope	4.99 SQ
16. Additional charge for steep roof - 7/12 to 9/12 slope	4.99 SQ

NOTES:

Grand Total Areas:

384.00 SF Walls	144.00 SF Ceiling	528.00 SF Walls and Ceiling
144.00 SF Floor	16.00 SY Flooring	48.00 LF Floor Perimeter
0.00 SF Long Wall	0.00 SF Short Wall	48.00 LF Ceil. Perimeter
144.00 Floor Area	160.44 Total Area	384.00 Interior Wall Area
2,099.94 Exterior Wall Area	50.67 Exterior Perimeter of Walls	
6,437.13 Surface Area	64.37 Number of Squares	577.82 Total Perimeter Length
180.75 Total Ridge Length	0.00 Total Hip Length	

T. Barrett & Associates
Address: PO Box 5069
Louisville, KY 40255
Phone: 502.365.1462
Fax: 502.290.2091
Toll Free: 1-877-770-1113

Insured: Winchester Lake Apartments LLC
Property: 6623-6651 Buntline Drive
Canal Winchester, OH 43110

Business: (614) 317-1781

Claim Rep.: Bob Greaser
Company: T. Barrett and Associates

Business: (317) 522-6757
E-mail: bobgreaser@yahoo.com

Estimator: Bob Greaser
Company: T. Barrett and Associates

Business: (317) 522-6757
E-mail: bobgreaser@yahoo.com

Claim Number: 2BDH3

Policy Number: HEICP-250163

Type of Loss: Wind Damage

Date Contacted: 5/1/2024 9:04 PM

Date of Loss: 3/14/2024 6:31 PM

Date Received: 5/1/2024 6:32 PM

Date Inspected: 5/17/2024 6:32 PM

Date Entered: 5/17/2024 6:29 PM

Price List: OHCO8X_MAY24
Restoration/Service/Remodel
Estimate: 2BDH3_WINDCHES_BLD17

This estimate of repair contains our repair recommendations, subject to review by the insurance company. No adjuster has authority to authorize repairs or guarantee payment.

Any person who knowingly and with intent to defraud any insurance company or another person, files a statement of claim containing any materially false information, or conceals for the purpose of misleading, information concerning any fact, material thereto, commits a fraudulent insurance act, which is a crime, subject to criminal prosecution.

T. Barrett & Associates
 Address: PO Box 5069
 Louisville, KY 40255
 Phone: 502.365.1462
 Fax: 502.290.2091
 Toll Free: 1-877-770-1113

2BDH3_WINDCHES_BLD17
BLDG 17 6623-6651 Buntline Drive
Main Level

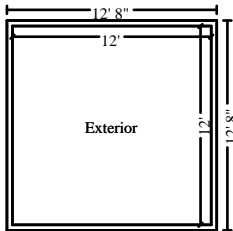

Exterior

Height: 8'

384.00 SF Walls	144.00 SF Ceiling
528.00 SF Walls & Ceiling	144.00 SF Floor
16.00 SY Flooring	48.00 LF Floor Perimeter
48.00 LF Ceil. Perimeter	

DESCRIPTION

QTY

1. Gutter - Labor Minimum Reset loose gutters.	1.00 EA
---	---------

NOTES:

Roof

Roof 17

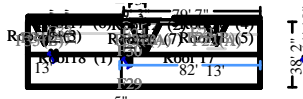

6437.13 Surface Area	64.37 Number of Squares
577.82 Total Perimeter Length	180.75 Total Ridge Length

DESCRIPTION

QTY

2. Remove Laminated - comp. shingle rfg. - w/out felt	64.37 SQ
3. Laminated - comp. shingle rfg. - w/out felt	71.00 SQ
4. Roofing felt - 15 lb.	47.14 SQ
5. Ice & water barrier	1550.03 SF

T. Barrett & Associates
 Address: PO Box 5069
 Louisville, KY 40255
 Phone: 502.365.1462
 Fax: 502.290.2091
 Toll Free: 1-877-770-1113

CONTINUED - Roof 17

DESCRIPTION	QTY
In valleys.	
6. R&R Valley metal - (W) profile - painted	108.59 LF
7. R&R Drip edge	577.82 LF
8. Asphalt starter - universal starter course	408.08 LF
9. Continuous ridge vent - shingle-over style	160.75 LF
10. Hip / Ridge cap - Standard profile - composition shingles	180.75 LF
11. Flashing - pipe jack	24.00 EA
12. Roof vent - turtle type - Metal	16.00 EA
13. Remove Additional charge for high roof (2 stories or greater)	54.40 SQ
14. Additional charge for high roof (2 stories or greater)	54.40 SQ
15. Remove Additional charge for steep roof - 7/12 to 9/12 slope	4.99 SQ
16. Additional charge for steep roof - 7/12 to 9/12 slope	4.99 SQ

NOTES:

Grand Total Areas:

384.00 SF Walls	144.00 SF Ceiling	528.00 SF Walls and Ceiling
144.00 SF Floor	16.00 SY Flooring	48.00 LF Floor Perimeter
0.00 SF Long Wall	0.00 SF Short Wall	48.00 LF Ceil. Perimeter
144.00 Floor Area	160.44 Total Area	384.00 Interior Wall Area
2,099.94 Exterior Wall Area	50.67 Exterior Perimeter of Walls	
6,437.13 Surface Area	64.37 Number of Squares	577.82 Total Perimeter Length
180.75 Total Ridge Length	0.00 Total Hip Length	

T. Barrett & Associates
Address: PO Box 5069
Louisville, KY 40255
Phone: 502.365.1462
Fax: 502.290.2091
Toll Free: 1-877-770-1113

Insured: Winchester Lake Apartments LLC
Property: 5603-5631 Gatling Drive
Canal Winchester, OH 43110

Business: (614) 317-1781

Claim Rep.: Bob Greaser
Company: T. Barrett and Associates

Business: (317) 522-6757
E-mail: bobgreaser@yahoo.com

Estimator: Bob Greaser
Company: T. Barrett and Associates

Business: (317) 522-6757
E-mail: bobgreaser@yahoo.com

Claim Number: 2BDH3

Policy Number: HEICP-250163

Type of Loss: Wind Damage

Date Contacted: 5/1/2024 10:48 PM

Date of Loss: 3/14/2024 6:31 PM

Date Received: 5/1/2024 6:32 PM

Date Inspected: 5/17/2024 6:32 PM

Date Entered: 5/17/2024 6:29 PM

Date Est. Completed: 7/15/2024 7:38 PM

Price List: OHCO8X_MAY24
Restoration/Service/Remodel

Estimate: 2BDH3_WINDCHES_BL16

This estimate of repair contains our repair recommendations, subject to review by the insurance company. No adjuster has authority to authorize repairs or guarantee payment.

Any person who knowingly and with intent to defraud any insurance company or another person, files a statement of claim containing any materially false information, or conceals for the purpose of misleading, information concerning any fact, material thereto, commits a fraudulent insurance act, which is a crime, subject to criminal prosecution.

T. Barrett & Associates
 Address: PO Box 5069
 Louisville, KY 40255
 Phone: 502.365.1462
 Fax: 502.290.2091
 Toll Free: 1-877-770-1113

2BDH3_WINDCHES_BL16
BLDG 16 - 5603-5631 Gatling Drive
Main Level

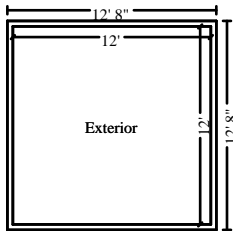

Exterior

Height: 8'

384.00 SF Walls	144.00 SF Ceiling
528.00 SF Walls & Ceiling	144.00 SF Floor
16.00 SY Flooring	48.00 LF Floor Perimeter
48.00 LF Ceil. Perimeter	

DESCRIPTION

QTY

1. R&R Fascia - metal - 8"	20.00 LF
----------------------------	----------

NOTES:

Roof

Roof 16



6437.13 Surface Area	64.37 Number of Squares
577.82 Total Perimeter Length	180.75 Total Ridge Length

DESCRIPTION

QTY

2. Remove Laminated - comp. shingle rfg. - w/out felt	64.37 SQ
3. Laminated - comp. shingle rfg. - w/out felt	71.00 SQ
4. Roofing felt - 15 lb.	47.14 SQ
5. Ice & water barrier	1550.03 SF
In valleys.	

T. Barrett & Associates
 Address: PO Box 5069
 Louisville, KY 40255
 Phone: 502.365.1462
 Fax: 502.290.2091
 Toll Free: 1-877-770-1113

CONTINUED - Roof 16

DESCRIPTION	QTY
6. R&R Valley metal - (W) profile - painted	108.59 LF
7. R&R Drip edge	577.82 LF
8. Asphalt starter - universal starter course	408.08 LF
9. Continuous ridge vent - shingle-over style	160.75 LF
10. Hip / Ridge cap - Standard profile - composition shingles	180.75 LF
11. Flashing - pipe jack	24.00 EA
12. Roof vent - turtle type - Metal	16.00 EA
13. Remove Additional charge for high roof (2 stories or greater)	54.40 SQ
14. Additional charge for high roof (2 stories or greater)	54.40 SQ
15. Remove Additional charge for steep roof - 7/12 to 9/12 slope	4.99 SQ
16. Additional charge for steep roof - 7/12 to 9/12 slope	4.99 SQ

NOTES:

Labor Minimums Applied

DESCRIPTION	QTY
17. Siding labor minimum	1.00 EA

NOTES:

T. Barrett & Associates
 Address: PO Box 5069
 Louisville, KY 40255
 Phone: 502.365.1462
 Fax: 502.290.2091
 Toll Free: 1-877-770-1113

Grand Total Areas:

384.00 SF Walls	144.00 SF Ceiling	528.00 SF Walls and Ceiling
144.00 SF Floor	16.00 SY Flooring	48.00 LF Floor Perimeter
0.00 SF Long Wall	0.00 SF Short Wall	48.00 LF Ceil. Perimeter
144.00 Floor Area	160.44 Total Area	384.00 Interior Wall Area
2,099.94 Exterior Wall Area	50.67 Exterior Perimeter of Walls	
6,437.13 Surface Area	64.37 Number of Squares	577.82 Total Perimeter Length
180.75 Total Ridge Length	0.00 Total Hip Length	

T. Barrett & Associates
Address: PO Box 5069
Louisville, KY 40255
Phone: 502.365.1462
Fax: 502.290.2091
Toll Free: 1-877-770-1113

Insured: Winchester Lake Apartments LLC
Property: Multiple
Canal Winchester, OH 43110

Business: (614) 317-1781

Claim Rep.: Bob Greaser
Company: T. Barrett and Associates

Business: (317) 522-6757
E-mail: bobgreaser@yahoo.com

Estimator: Bob Greaser
Company: T. Barrett and Associates

Business: (317) 522-6757
E-mail: bobgreaser@yahoo.com

Claim Number: 2BDH3

Policy Number: HEICP-250163

Type of Loss: Wind Damage

Date Contacted: 5/1/2024 10:54 AM

Date of Loss: 3/14/2024 6:31 PM

Date Inspected: 5/17/2024 6:32 PM

Date Received: 5/1/2024 6:32 PM

Date Entered: 5/17/2024 6:29 PM

Price List: OHCO8X_MAY24
Restoration/Service/Remodel

Estimate: 2BDH3_WIND_LAKE-B15

This estimate of repair contains our repair recommendations, subject to review by the insurance company. No adjuster has authority to authorize repairs or guarantee payment.

Any person who knowingly and with intent to defraud any insurance company or another person, files a statement of claim containing any materially false information, or conceals for the purpose of misleading, information concerning any fact, material thereto, commits a fraudulent insurance act, which is a crime, subject to criminal prosecution.

T. Barrett & Associates
 Address: PO Box 5069
 Louisville, KY 40255
 Phone: 502.365.1462
 Fax: 502.290.2091
 Toll Free: 1-877-770-1113

2BDH3_WIND_LAKE-B15

BLDG 15-6661-6689 Kodiak

Roof



Roof22

6436.95 Surface Area	64.37 Number of Squares
575.81 Total Perimeter Length	180.75 Total Ridge Length

DESCRIPTION

QTY

221. Remove Laminated - comp. shingle rfg. - w/out felt	64.37 SQ
223. Laminated - comp. shingle rfg. - w/out felt	71.00 SQ
224. Roofing felt - 15 lb.	47.14 SQ
225. Ice & water barrier	1550.03 SF
In valleys.	
226. R&R Valley metal - (W) profile - painted	108.59 LF
227. R&R Drip edge	575.81 LF
228. Asphalt starter - universal starter course	408.08 LF
229. Continuous ridge vent - shingle-over style	180.00 LF
230. Hip / Ridge cap - Standard profile - composition shingles	180.75 LF
231. Flashing - pipe jack	24.00 EA
232. Roof vent - turtle type - Metal	16.00 EA

NOTES:

T. Barrett & Associates
 Address: PO Box 5069
 Louisville, KY 40255
 Phone: 502.365.1462
 Fax: 502.290.2091
 Toll Free: 1-877-770-1113

Grand Total Areas:

384.00 SF Walls	144.00 SF Ceiling	528.00 SF Walls and Ceiling
144.00 SF Floor	16.00 SY Flooring	48.00 LF Floor Perimeter
0.00 SF Long Wall	0.00 SF Short Wall	48.00 LF Ceil. Perimeter
144.00 Floor Area	160.44 Total Area	384.00 Interior Wall Area
2,127.29 Exterior Wall Area	50.67 Exterior Perimeter of Walls	
6,436.95 Surface Area	64.37 Number of Squares	575.81 Total Perimeter Length
180.75 Total Ridge Length	0.00 Total Hip Length	

T. Barrett & Associates
Address: PO Box 5069
Louisville, KY 40255
Phone: 502.365.1462
Fax: 502.290.2091
Toll Free: 1-877-770-1113

Insured: Winchester Lake Apartments LLC
Property: 6621-6649 Kodiak Drive
Canal Winchester, OH 43110

Business: (614) 317-1781

Claim Rep.: Bob Greaser
Company: T. Barrett and Associates

Business: (317) 522-6757
E-mail: bobgreaser@yahoo.com

Estimator: Bob Greaser
Company: T. Barrett and Associates

Business: (317) 522-6757
E-mail: bobgreaser@yahoo.com

Claim Number: 2BDH3

Policy Number: HEICP-250163

Type of Loss: Wind Damage

Date Contacted: 5/1/2024 7:09 PM

Date of Loss: 3/14/2024 6:31 PM

Date Received: 5/1/2024 6:32 PM

Date Inspected: 5/17/2024 6:32 PM

Date Entered: 5/17/2024 6:29 PM

Price List: OHCO8X_MAY24
Restoration/Service/Remodel
Estimate: 2BDH3_WIND_LAKE-B14

This estimate of repair contains our repair recommendations, subject to review by the insurance company. No adjuster has authority to authorize repairs or guarantee payment.

Any person who knowingly and with intent to defraud any insurance company or another person, files a statement of claim containing any materially false information, or conceals for the purpose of misleading, information concerning any fact, material thereto, commits a fraudulent insurance act, which is a crime, subject to criminal prosecution.

T. Barrett & Associates
 Address: PO Box 5069
 Louisville, KY 40255
 Phone: 502.365.1462
 Fax: 502.290.2091
 Toll Free: 1-877-770-1113

2BDH3_WIND_LAKE-B14
BLDG 20 6655 Kodiak Drive
Roof

Roof 14



6437.13 Surface Area	64.37 Number of Squares
575.81 Total Perimeter Length	180.75 Total Ridge Length

DESCRIPTION	QTY
221. Remove Laminated - comp. shingle rfg. - w/out felt	64.37 SQ
223. Laminated - comp. shingle rfg. - w/out felt	71.00 SQ
224. Roofing felt - 15 lb.	47.14 SQ
225. Ice & water barrier	1550.03 SF
In valleys.	
226. R&R Valley metal - (W) profile - painted	108.59 LF
227. R&R Drip edge	575.81 LF
228. Asphalt starter - universal starter course	408.08 LF
229. Continuous ridge vent - shingle-over style	160.75 LF
230. Hip / Ridge cap - Standard profile - composition shingles	180.75 LF
231. Flashing - pipe jack	24.00 EA
232. Roof vent - turtle type - Metal	16.00 EA
233. Remove Additional charge for high roof (2 stories or greater)	54.40 SQ
234. Additional charge for high roof (2 stories or greater)	54.40 SQ
235. Remove Additional charge for steep roof - 7/12 to 9/12 slope	4.99 SQ
236. Additional charge for steep roof - 7/12 to 9/12 slope	4.99 SQ

NOTES:

T. Barrett & Associates
 Address: PO Box 5069
 Louisville, KY 40255
 Phone: 502.365.1462
 Fax: 502.290.2091
 Toll Free: 1-877-770-1113

Grand Total Areas:

384.00 SF Walls	144.00 SF Ceiling	528.00 SF Walls and Ceiling
144.00 SF Floor	16.00 SY Flooring	48.00 LF Floor Perimeter
0.00 SF Long Wall	0.00 SF Short Wall	48.00 LF Ceil. Perimeter
144.00 Floor Area	160.44 Total Area	384.00 Interior Wall Area
2,127.29 Exterior Wall Area	50.67 Exterior Perimeter of Walls	
6,437.13 Surface Area	64.37 Number of Squares	575.81 Total Perimeter Length
180.75 Total Ridge Length	0.00 Total Hip Length	

T. Barrett & Associates
Address: PO Box 5069
Louisville, KY 40255
Phone: 502.365.1462
Fax: 502.290.2091
Toll Free: 1-877-770-1113

Insured: Winchester Lake Apartments LLC
Property: 5630-5666 Gatling Drive
Canal Winchester, OH 43110

Business: (614) 317-1781

Claim Rep.: Bob Greaser
Company: T. Barrett and Associates

Business: (317) 522-6757
E-mail: bobgreaser@yahoo.com

Estimator: Bob Greaser
Company: T. Barrett and Associates

Business: (317) 522-6757
E-mail: bobgreaser@yahoo.com

Claim Number: 2BDH3

Policy Number: HEICP-250163

Type of Loss: Wind Damage

Date Contacted: 5/1/2024 10:01 PM

Date of Loss: 3/14/2024 6:31 PM

Date Received: 5/1/2024 6:32 PM

Date Inspected: 5/17/2024 6:32 PM

Date Entered: 5/17/2024 6:29 PM

Date Est. Completed: 7/15/2024 10:38 PM

Price List: OHCO8X_MAY24
Restoration/Service/Remodel

Estimate: 2BDH3_WIND_LAKE-B13

This estimate of repair contains our repair recommendations, subject to review by the insurance company. No adjuster has authority to authorize repairs or guarantee payment.

Any person who knowingly and with intent to defraud any insurance company or another person, files a statement of claim containing any materially false information, or conceals for the purpose of misleading, information concerning any fact, material thereto, commits a fraudulent insurance act, which is a crime, subject to criminal prosecution.

T. Barrett & Associates
 Address: PO Box 5069
 Louisville, KY 40255
 Phone: 502.365.1462
 Fax: 502.290.2091
 Toll Free: 1-877-770-1113

2BDH3_WIND_LAKE-B13
BLDG 13 - 5630 Gatling
Exterior

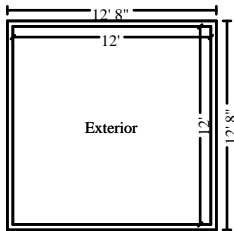

Exterior

Height: 8'

384.00 SF Walls	144.00 SF Ceiling
528.00 SF Walls & Ceiling	144.00 SF Floor
16.00 SY Flooring	48.00 LF Floor Perimeter
48.00 LF Ceil. Perimeter	

DESCRIPTION

QTY

1. Siding - Labor Minimum	1.00 EA
---------------------------	---------

NOTES:

Roof



Roof 13

8896.09 Surface Area	88.96 Number of Squares
767.37 Total Perimeter Length	276.04 Total Ridge Length

DESCRIPTION

QTY

2. Remove Laminated - comp. shingle rfg. - w/out felt	88.96 SQ
3. Laminated - comp. shingle rfg. - w/out felt	98.00 SQ
4. Roofing felt - 15 lb.	67.58 SQ
5. Ice & water barrier In valleys.	2138.36 SF

T. Barrett & Associates
 Address: PO Box 5069
 Louisville, KY 40255
 Phone: 502.365.1462
 Fax: 502.290.2091
 Toll Free: 1-877-770-1113

CONTINUED - Roof 13

DESCRIPTION	QTY
6. R&R Valley metal - (W) profile - painted	188.20 LF
7. R&R Drip edge	767.37 LF
8. Asphalt starter - universal starter course	524.58 LF
9. Continuous ridge vent - shingle-over style	256.04 LF
10. Hip / Ridge cap - Standard profile - composition shingles	256.04 LF
11. Flashing - pipe jack	30.00 EA
12. Roof vent - turtle type - Metal	20.00 EA
13. Remove Additional charge for high roof (2 stories or greater)	85.08 SQ
14. Additional charge for high roof (2 stories or greater)	85.08 SQ
15. Remove Additional charge for steep roof - 10/12 - 12/12 slope	8.51 SQ
16. Additional charge for steep roof - 10/12 - 12/12 slope	8.51 SQ

NOTES:

Grand Total Areas:

384.00 SF Walls	144.00 SF Ceiling	528.00 SF Walls and Ceiling
144.00 SF Floor	16.00 SY Flooring	48.00 LF Floor Perimeter
0.00 SF Long Wall	0.00 SF Short Wall	48.00 LF Ceil. Perimeter
144.00 Floor Area	160.44 Total Area	384.00 Interior Wall Area
2,765.56 Exterior Wall Area	50.67 Exterior Perimeter of Walls	
8,896.09 Surface Area	88.96 Number of Squares	767.37 Total Perimeter Length
276.04 Total Ridge Length	0.00 Total Hip Length	

T. Barrett & Associates
Address: PO Box 5069
Louisville, KY 40255
Phone: 502.365.1462
Fax: 502.290.2091
Toll Free: 1-877-770-1113

Insured: Winchester Lake Apartments LLC
Property: 6716-6736 Kokiak Drive
Canal Winchester, OH 43110

Business: (614) 317-1781

Claim Rep.: Bob Greaser
Company: T. Barrett and Associates

Business: (317) 522-6757
E-mail: bobgreaser@yahoo.com

Estimator: Bob Greaser
Company: T. Barrett and Associates

Business: (317) 522-6757
E-mail: bobgreaser@yahoo.com

Claim Number: 2BDH3

Policy Number: HEICP-250163

Type of Loss: Wind Damage

Date Contacted: 5/1/2024 9:55 AM

Date of Loss: 3/14/2024 6:31 PM

Date Inspected: 5/17/2024 6:32 PM

Date Received: 5/1/2024 6:32 PM

Date Entered: 5/17/2024 6:29 PM

Price List: OHCO8X_MAY24
Restoration/Service/Remodel

Estimate: 2BDH3_WIND_LAKE-B12

This estimate of repair contains our repair recommendations, subject to review by the insurance company. No adjuster has authority to authorize repairs or guarantee payment.

Any person who knowingly and with intent to defraud any insurance company or another person, files a statement of claim containing any materially false information, or conceals for the purpose of misleading, information concerning any fact, material thereto, commits a fraudulent insurance act, which is a crime, subject to criminal prosecution.

T. Barrett & Associates
 Address: PO Box 5069
 Louisville, KY 40255
 Phone: 502.365.1462
 Fax: 502.290.2091
 Toll Free: 1-877-770-1113

2BDH3_WIND_LAKE-B12
BLDG 12: 6716-6736 Kodiak
Roof

Roof 12

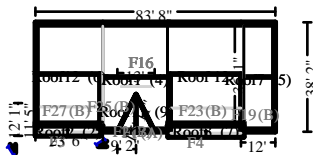

3822.02 Surface Area	38.22 Number of Squares
407.31 Total Perimeter Length	96.67 Total Ridge Length

DESCRIPTION

QTY

1. Remove Laminated - comp. shingle rfg. - w/out felt	38.22 SQ
2. Laminated - comp. shingle rfg. - w/out felt	42.33 SQ
3. Roofing felt - 15 lb.	20.99 SQ
4. Ice & water barrier	753.28 SF
In valleys.	
5. R&R Valley metal - (W) profile - painted	31.84 LF
6. R&R Drip edge	407.31 LF
7. Asphalt starter - universal starter course	219.25 LF
8. Continuous ridge vent - shingle-over style	180.00 LF
9. Hip / Ridge cap - Standard profile - composition shingles	96.67 LF
10. Flashing - pipe jack	24.00 EA
11. Roof vent - turtle type - Metal	16.00 EA

NOTES:

T. Barrett & Associates
 Address: PO Box 5069
 Louisville, KY 40255
 Phone: 502.365.1462
 Fax: 502.290.2091
 Toll Free: 1-877-770-1113

Grand Total Areas:

384.00 SF Walls	144.00 SF Ceiling	528.00 SF Walls and Ceiling
144.00 SF Floor	16.00 SY Flooring	48.00 LF Floor Perimeter
0.00 SF Long Wall	0.00 SF Short Wall	48.00 LF Ceil. Perimeter
144.00 Floor Area	160.44 Total Area	384.00 Interior Wall Area
2,760.95 Exterior Wall Area	50.67 Exterior Perimeter of Walls	
3,822.02 Surface Area	38.22 Number of Squares	407.31 Total Perimeter Length
96.67 Total Ridge Length	0.00 Total Hip Length	

T. Barrett & Associates
Address: PO Box 5069
Louisville, KY 40255
Phone: 502.365.1462
Fax: 502.290.2091
Toll Free: 1-877-770-1113

Insured: Winchester Lake Apartments LLC
Property: 6655 Kodiak Drive
Canal Winchester, OH 43110

Business: (614) 317-1781

Claim Rep.: Bob Greaser
Company: T. Barrett and Associates

Business: (317) 522-6757
E-mail: bobgreaser@yahoo.com

Estimator: Bob Greaser
Company: T. Barrett and Associates

Business: (317) 522-6757
E-mail: bobgreaser@yahoo.com

Claim Number: 2BDH3

Policy Number: HEICP-250163

Type of Loss: Wind Damage

Date Contacted: 5/1/2024 10:13 PM

Date of Loss: 3/14/2024 6:31 PM

Date Received: 5/1/2024 6:32 PM

Date Inspected: 5/17/2024 6:32 PM

Date Entered: 5/17/2024 6:29 PM

Price List: OHCO8X_MAY24
Restoration/Service/Remodel
Estimate: 2BDH3_WIND_LAKE-BL11

This estimate of repair contains our repair recommendations, subject to review by the insurance company. No adjuster has authority to authorize repairs or guarantee payment.

Any person who knowingly and with intent to defraud any insurance company or another person, files a statement of claim containing any materially false information, or conceals for the purpose of misleading, information concerning any fact, material thereto, commits a fraudulent insurance act, which is a crime, subject to criminal prosecution.

T. Barrett & Associates
Address: PO Box 5069
Louisville, KY 40255
Phone: 502.365.1462
Fax: 502.290.2091
Toll Free: 1-877-770-1113

Insured: Winchester Lake Apartments LLC
Property: 5655-5683 Buntline Dr
Canal Winchester, OH 43110

Business: (614) 317-1781

Claim Rep.: Bob Greaser
Company: T. Barrett and Associates

Business: (317) 522-6757
E-mail: bobgreaser@yahoo.com

Estimator: Bob Greaser
Company: T. Barrett and Associates

Business: (317) 522-6757
E-mail: bobgreaser@yahoo.com

Claim Number: 2BDH3

Policy Number: HEICP-250163

Type of Loss: Wind Damage

Date Contacted: 5/1/2024 10:48 PM

Date of Loss: 3/14/2024 6:31 PM

Date Inspected: 5/17/2024 6:32 PM

Date Received: 5/1/2024 6:32 PM

Date Entered: 5/17/2024 6:29 PM

Price List: OHCO8X_MAY24
Restoration/Service/Remodel
Estimate: 2BDH3_WINDCHES_BL10

This estimate of repair contains our repair recommendations, subject to review by the insurance company. No adjuster has authority to authorize repairs or guarantee payment.

Any person who knowingly and with intent to defraud any insurance company or another person, files a statement of claim containing any materially false information, or conceals for the purpose of misleading, information concerning any fact, material thereto, commits a fraudulent insurance act, which is a crime, subject to criminal prosecution.

T. Barrett & Associates
 Address: PO Box 5069
 Louisville, KY 40255
 Phone: 502.365.1462
 Fax: 502.290.2091
 Toll Free: 1-877-770-1113

2BDH3_WINDCHES_BL10
BLDG 10 - 5655-5683 Buntline Dr
Roof

Roof 10

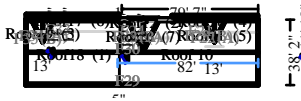

6437.13 Surface Area	64.37 Number of Squares
577.82 Total Perimeter Length	180.75 Total Ridge Length

DESCRIPTION

QTY

1. Remove Laminated - comp. shingle rfg. - w/out felt	64.37 SQ
2. Laminated - comp. shingle rfg. - w/out felt	71.00 SQ
3. Roofing felt - 15 lb.	47.14 SQ
4. Ice & water barrier	1550.03 SF
In valleys.	
5. R&R Valley metal - (W) profile - painted	108.59 LF
6. R&R Drip edge	577.82 LF
7. Asphalt starter - universal starter course	408.08 LF
8. Continuous ridge vent - shingle-over style	160.75 LF
9. Hip / Ridge cap - Standard profile - composition shingles	180.75 LF
10. Flashing - pipe jack	24.00 EA
11. Roof vent - turtle type - Metal	16.00 EA
12. Remove Additional charge for high roof (2 stories or greater)	54.40 SQ
13. Additional charge for high roof (2 stories or greater)	54.40 SQ
14. Remove Additional charge for steep roof - 7/12 to 9/12 slope	4.99 SQ
15. Additional charge for steep roof - 7/12 to 9/12 slope	4.99 SQ

NOTES:

T. Barrett & Associates
 Address: PO Box 5069
 Louisville, KY 40255
 Phone: 502.365.1462
 Fax: 502.290.2091
 Toll Free: 1-877-770-1113

Grand Total Areas:

384.00 SF Walls	144.00 SF Ceiling	528.00 SF Walls and Ceiling
144.00 SF Floor	16.00 SY Flooring	48.00 LF Floor Perimeter
0.00 SF Long Wall	0.00 SF Short Wall	48.00 LF Ceil. Perimeter
144.00 Floor Area	160.44 Total Area	384.00 Interior Wall Area
2,099.94 Exterior Wall Area	50.67 Exterior Perimeter of Walls	
6,437.13 Surface Area	64.37 Number of Squares	577.82 Total Perimeter Length
180.75 Total Ridge Length	0.00 Total Hip Length	

T. Barrett & Associates
Address: PO Box 5069
Louisville, KY 40255
Phone: 502.365.1462
Fax: 502.290.2091
Toll Free: 1-877-770-1113

Insured: Winchester Lake Apartments LLC
Property: 5685-5713 Xebec Drive
Canal Winchester, OH 43110

Business: (614) 317-1781

Claim Rep.: Bob Greaser
Company: T. Barrett and Associates

Business: (317) 522-6757
E-mail: bobgreaser@yahoo.com

Estimator: Bob Greaser
Company: T. Barrett and Associates

Business: (317) 522-6757
E-mail: bobgreaser@yahoo.com

Claim Number: 2BDH3

Policy Number: HEICP-250163

Type of Loss: Wind Damage

Date Contacted: 5/1/2024 11:07 PM

Date of Loss: 3/14/2024 6:31 PM

Date Received: 5/1/2024 6:32 PM

Date Inspected: 5/17/2024 6:32 PM

Date Entered: 5/17/2024 6:29 PM

Date Est. Completed: 7/15/2024 6:46 PM

Price List: OHCO8X_MAY24
Restoration/Service/Remodel

Estimate: 2BDH3_WIND_LAKE-BL9

This estimate of repair contains our repair recommendations, subject to review by the insurance company. No adjuster has authority to authorize repairs or guarantee payment.

Any person who knowingly and with intent to defraud any insurance company or another person, files a statement of claim containing any materially false information, or conceals for the purpose of misleading, information concerning any fact, material thereto, commits a fraudulent insurance act, which is a crime, subject to criminal prosecution.

T. Barrett & Associates
 Address: PO Box 5069
 Louisville, KY 40255
 Phone: 502.365.1462
 Fax: 502.290.2091
 Toll Free: 1-877-770-1113

2BDH3_WIND_LAKE-BL9
BLDG 9 - 5685-5713 Xebec Drive
Exterior

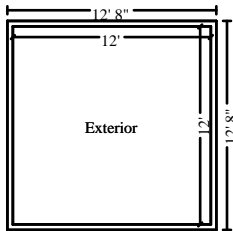

Exterior

Height: 8'

384.00 SF Walls	144.00 SF Ceiling
528.00 SF Walls & Ceiling	144.00 SF Floor
16.00 SY Flooring	48.00 LF Floor Perimeter
48.00 LF Ceil. Perimeter	

DESCRIPTION

QTY

1. R&R Clothes dryer vent cover	1.00 EA
---------------------------------	---------

NOTES:

Roof

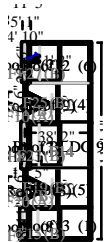

Roof BLDG 9

5248.63 Surface Area	52.49 Number of Squares
537.99 Total Perimeter Length	140.08 Total Ridge Length

DESCRIPTION

QTY

2. Remove Laminated - comp. shingle rfg. - w/out felt	52.49 SQ
3. Laminated - comp. shingle rfg. - w/out felt	58.00 SQ
4. Roofing felt - 15 lb.	41.61 SQ
5. Ice & water barrier In valleys.	1087.56 SF

T. Barrett & Associates
 Address: PO Box 5069
 Louisville, KY 40255
 Phone: 502.365.1462
 Fax: 502.290.2091
 Toll Free: 1-877-770-1113

CONTINUED - Roof BLDG 9

DESCRIPTION	QTY
6. Roof vent - turtle type - Metal	16.00 EA
7. R&R Valley metal - (W) profile - painted	63.69 LF
8. R&R Drip edge	537.99 LF
9. Asphalt starter - universal starter course	298.83 LF
10. Continuous ridge vent - shingle-over style	120.08 LF
11. Hip / Ridge cap - Standard profile - composition shingles	140.08 LF
12. Flashing - pipe jack	24.00 EA
13. Remove Additional charge for high roof (2 stories or greater)	48.75 SQ
14. Additional charge for high roof (2 stories or greater)	48.75 SQ
15. Remove Additional charge for steep roof - 10/12 - 12/12 slope	2.39 SQ
16. Additional charge for steep roof - 10/12 - 12/12 slope	2.39 SQ

NOTES:

Labor Minimums Applied

DESCRIPTION	QTY
17. Heat, vent, & air cond. labor minimum	1.00 EA

NOTES:

T. Barrett & Associates
 Address: PO Box 5069
 Louisville, KY 40255
 Phone: 502.365.1462
 Fax: 502.290.2091
 Toll Free: 1-877-770-1113

Grand Total Areas:

384.00 SF Walls	144.00 SF Ceiling	528.00 SF Walls and Ceiling
144.00 SF Floor	16.00 SY Flooring	48.00 LF Floor Perimeter
0.00 SF Long Wall	0.00 SF Short Wall	48.00 LF Ceil. Perimeter
144.00 Floor Area	160.44 Total Area	384.00 Interior Wall Area
3,535.63 Exterior Wall Area	50.67 Exterior Perimeter of Walls	
5,248.63 Surface Area	52.49 Number of Squares	537.99 Total Perimeter Length
140.08 Total Ridge Length	0.00 Total Hip Length	

T. Barrett & Associates
Address: PO Box 5069
Louisville, KY 40255
Phone: 502.365.1462
Fax: 502.290.2091
Toll Free: 1-877-770-1113

Insured: Winchester Lake Apartments LLC
Property: 5598-5626 Xebec Drive
Canal Winchester, OH 43110

Business: (614) 317-1781

Claim Rep.: Bob Greaser
Company: T. Barrett and Associates

Business: (317) 522-6757
E-mail: bobgreaser@yahoo.com

Estimator: Bob Greaser
Company: T. Barrett and Associates

Business: (317) 522-6757
E-mail: bobgreaser@yahoo.com

Claim Number: 2BDH3

Policy Number: HEICP-250163

Type of Loss: Wind Damage

Date Contacted: 5/1/2024 10:48 PM

Date of Loss: 3/14/2024 6:31 PM

Date Inspected: 5/17/2024 6:32 PM

Date Received: 5/1/2024 6:32 PM

Date Entered: 5/17/2024 6:29 PM

Price List: OHCO8X_MAY24
Restoration/Service/Remodel

Estimate: 2BDH3_WINDCHES_BL8

This estimate of repair contains our repair recommendations, subject to review by the insurance company. No adjuster has authority to authorize repairs or guarantee payment.

Any person who knowingly and with intent to defraud any insurance company or another person, files a statement of claim containing any materially false information, or conceals for the purpose of misleading, information concerning any fact, material thereto, commits a fraudulent insurance act, which is a crime, subject to criminal prosecution.

T. Barrett & Associates
 Address: PO Box 5069
 Louisville, KY 40255
 Phone: 502.365.1462
 Fax: 502.290.2091
 Toll Free: 1-877-770-1113

2BDH3_WINDCHES_BL8
BLDG 8 - 5598-5626 Xebec Drive
Roof



Roof22

6436.95 Surface Area	64.37 Number of Squares
575.81 Total Perimeter Length	180.75 Total Ridge Length

DESCRIPTION

QTY

17. Remove Laminated - comp. shingle rfg. - w/out felt	64.37 SQ
19. Laminated - comp. shingle rfg. - w/out felt	71.00 SQ
20. Roofing felt - 15 lb.	47.14 SQ
21. Ice & water barrier	1550.03 SF
In valleys.	
22. R&R Valley metal - (W) profile - painted	108.59 LF
23. R&R Drip edge	575.81 LF
24. Asphalt starter - universal starter course	408.08 LF
25. Continuous ridge vent - shingle-over style	180.00 LF
26. Hip / Ridge cap - Standard profile - composition shingles	180.75 LF
27. Flashing - pipe jack	24.00 EA
28. Roof vent - turtle type - Metal	16.00 EA

NOTES:

T. Barrett & Associates
 Address: PO Box 5069
 Louisville, KY 40255
 Phone: 502.365.1462
 Fax: 502.290.2091
 Toll Free: 1-877-770-1113

Grand Total Areas:

384.00 SF Walls	144.00 SF Ceiling	528.00 SF Walls and Ceiling
144.00 SF Floor	16.00 SY Flooring	48.00 LF Floor Perimeter
0.00 SF Long Wall	0.00 SF Short Wall	48.00 LF Ceil. Perimeter
144.00 Floor Area	160.44 Total Area	384.00 Interior Wall Area
2,099.94 Exterior Wall Area	50.67 Exterior Perimeter of Walls	
6,436.95 Surface Area	64.37 Number of Squares	575.81 Total Perimeter Length
180.75 Total Ridge Length	0.00 Total Hip Length	

T. Barrett & Associates
Address: PO Box 5069
Louisville, KY 40255
Phone: 502.365.1462
Fax: 502.290.2091
Toll Free: 1-877-770-1113

Insured: Winchester Lake Apartments LLC
Property: 5672-5700 Xebec Drive
Canal Winchester, OH 43110

Business: (614) 317-1781

Claim Rep.: Bob Greaser
Company: T. Barrett and Associates

Business: (317) 522-6757
E-mail: bobgreaser@yahoo.com

Estimator: Bob Greaser
Company: T. Barrett and Associates

Business: (317) 522-6757
E-mail: bobgreaser@yahoo.com

Claim Number: 2BDH3

Policy Number: HEICP-250163

Type of Loss: Wind Damage

Date Contacted: 5/1/2024 10:48 PM

Date of Loss: 3/14/2024 6:31 PM

Date Received: 5/1/2024 6:32 PM

Date Inspected: 5/17/2024 6:32 PM

Date Entered: 5/17/2024 6:29 PM

Date Est. Completed: 7/15/2024 6:45 PM

Price List: OHCO8X_MAY24
Restoration/Service/Remodel

Estimate: 2BDH3_WINDCHES_BL7

This estimate of repair contains our repair recommendations, subject to review by the insurance company. No adjuster has authority to authorize repairs or guarantee payment.

Any person who knowingly and with intent to defraud any insurance company or another person, files a statement of claim containing any materially false information, or conceals for the purpose of misleading, information concerning any fact, material thereto, commits a fraudulent insurance act, which is a crime, subject to criminal prosecution.

T. Barrett & Associates
 Address: PO Box 5069
 Louisville, KY 40255
 Phone: 502.365.1462
 Fax: 502.290.2091
 Toll Free: 1-877-770-1113

2BDH3_WINDCHES_BL7
BLDG 7 - 5672-5700 Xebec Drive
Main Level

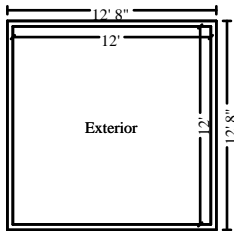

Exterior

Height: 8'

384.00 SF Walls	144.00 SF Ceiling
528.00 SF Walls & Ceiling	144.00 SF Floor
16.00 SY Flooring	48.00 LF Floor Perimeter
48.00 LF Ceil. Perimeter	

DESCRIPTION

QTY

1. R&R Fascia - metal - 8"	30.00 LF
----------------------------	----------

NOTES:

Roof

Roof 7

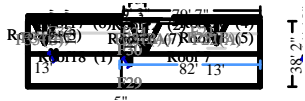

6437.13 Surface Area	64.37 Number of Squares
577.82 Total Perimeter Length	180.75 Total Ridge Length

DESCRIPTION

QTY

2. Remove Laminated - comp. shingle rfg. - w/out felt	64.37 SQ
3. Laminated - comp. shingle rfg. - w/out felt	71.00 SQ
4. Roofing felt - 15 lb.	47.14 SQ
5. Ice & water barrier	1550.03 SF
In valleys.	

T. Barrett & Associates
 Address: PO Box 5069
 Louisville, KY 40255
 Phone: 502.365.1462
 Fax: 502.290.2091
 Toll Free: 1-877-770-1113

CONTINUED - Roof 7

DESCRIPTION	QTY
6. R&R Valley metal - (W) profile - painted	108.59 LF
7. R&R Drip edge	577.82 LF
8. Asphalt starter - universal starter course	408.08 LF
9. Continuous ridge vent - shingle-over style	160.75 LF
10. Hip / Ridge cap - Standard profile - composition shingles	180.75 LF
11. Flashing - pipe jack	24.00 EA
12. Roof vent - turtle type - Metal	16.00 EA
13. Remove Additional charge for high roof (2 stories or greater)	54.40 SQ
14. Additional charge for high roof (2 stories or greater)	54.40 SQ
15. Remove Additional charge for steep roof - 7/12 to 9/12 slope	4.99 SQ
16. Additional charge for steep roof - 7/12 to 9/12 slope	4.99 SQ

NOTES:

Labor Minimums Applied

DESCRIPTION	QTY
17. Siding labor minimum	1.00 EA

NOTES:

T. Barrett & Associates
 Address: PO Box 5069
 Louisville, KY 40255
 Phone: 502.365.1462
 Fax: 502.290.2091
 Toll Free: 1-877-770-1113

Grand Total Areas:

384.00 SF Walls	144.00 SF Ceiling	528.00 SF Walls and Ceiling
144.00 SF Floor	16.00 SY Flooring	48.00 LF Floor Perimeter
0.00 SF Long Wall	0.00 SF Short Wall	48.00 LF Ceil. Perimeter
144.00 Floor Area	160.44 Total Area	384.00 Interior Wall Area
2,099.94 Exterior Wall Area	50.67 Exterior Perimeter of Walls	
6,437.13 Surface Area	64.37 Number of Squares	577.82 Total Perimeter Length
180.75 Total Ridge Length	0.00 Total Hip Length	

T. Barrett & Associates
Address: PO Box 5069
Louisville, KY 40255
Phone: 502.365.1462
Fax: 502.290.2091
Toll Free: 1-877-770-1113

Insured: Winchester Lake Apartments LLC
Property: 5596-5624 Gatling Drive
Canal Winchester, OH 43110

Business: (614) 317-1781

Claim Rep.: Bob Greaser
Company: T. Barrett and Associates

Business: (317) 522-6757
E-mail: bobgreaser@yahoo.com

Estimator: Bob Greaser
Company: T. Barrett and Associates

Business: (317) 522-6757
E-mail: bobgreaser@yahoo.com

Claim Number: 2BDH3

Policy Number: HEICP-250163

Type of Loss: Wind Damage

Date of Loss: 3/14/2024 6:31 PM
Date Inspected: 5/17/2024 6:32 PM

Date Received: 5/1/2024 6:32 PM
Date Entered: 5/17/2024 6:29 PM

Price List: OHCO8X_MAY24
Restoration/Service/Remodel
Estimate: 2BDH3_WINDCHEST_BL-6

This estimate of repair contains our repair recommendations, subject to review by the insurance company. No adjuster has authority to authorize repairs or guarantee payment.

Any person who knowingly and with intent to defraud any insurance company or another person, files a statement of claim containing any materially false information, or conceals for the purpose of misleading, information concerning any fact, material thereto, commits a fraudulent insurance act, which is a crime, subject to criminal prosecution.

T. Barrett & Associates
 Address: PO Box 5069
 Louisville, KY 40255
 Phone: 502.365.1462
 Fax: 502.290.2091
 Toll Free: 1-877-770-1113

2BDH3_WINDCHEST_BL-6
BLDG 6 - 5596-5624 Gatling Drive
Roof



Roof BLDG 1

7376.96 Surface Area	73.77 Number of Squares
664.82 Total Perimeter Length	208.42 Total Ridge Length

DESCRIPTION

QTY

1. Remove Laminated - comp. shingle rfg. - w/out felt	73.77 SQ
2. Laminated - comp. shingle rfg. - w/out felt	81.33 SQ
3. Roofing felt - 15 lb.	56.54 SQ
4. Ice & water barrier	1723.44 SF
In valleys.	
5. Valley metal - (W) profile - painted	109.31 LF
6. Drip edge	664.82 LF
7. Asphalt starter - universal starter course	465.17 LF
8. Continuous ridge vent - shingle-over style	160.00 LF
9. Hip / Ridge cap - Standard profile - composition shingles	208.42 LF
10. Flashing - pipe jack	24.00 EA
11. Roof vent - turtle type - Metal	16.00 EA
12. Remove Additional charge for high roof (2 stories or greater)	71.21 SQ
13. Additional charge for high roof (2 stories or greater)	71.21 SQ
14. Remove Additional charge for steep roof - 10/12 - 12/12 slope	4.76 SQ
15. Additional charge for steep roof - 10/12 - 12/12 slope	4.76 SQ

NOTES:

T. Barrett & Associates
 Address: PO Box 5069
 Louisville, KY 40255
 Phone: 502.365.1462
 Fax: 502.290.2091
 Toll Free: 1-877-770-1113

Grand Total Areas:

384.00 SF Walls	144.00 SF Ceiling	528.00 SF Walls and Ceiling
144.00 SF Floor	16.00 SY Flooring	48.00 LF Floor Perimeter
0.00 SF Long Wall	0.00 SF Short Wall	48.00 LF Ceil. Perimeter
144.00 Floor Area	160.44 Total Area	384.00 Interior Wall Area
2,376.03 Exterior Wall Area	50.67 Exterior Perimeter of Walls	
7,376.96 Surface Area	73.77 Number of Squares	664.82 Total Perimeter Length
208.42 Total Ridge Length	0.00 Total Hip Length	

T. Barrett & Associates
Address: PO Box 5069
Louisville, KY 40255
Phone: 502.365.1462
Fax: 502.290.2091
Toll Free: 1-877-770-1113

Insured: Winchester Lake Apartments LLC
Property: 6680-6708 Kodiak Drive
Canal Winchester, OH 43110

Business: (614) 317-1781

Claim Rep.: Bob Greaser
Company: T. Barrett and Associates

Business: (317) 522-6757
E-mail: bobgreaser@yahoo.com

Estimator: Bob Greaser
Company: T. Barrett and Associates

Business: (317) 522-6757
E-mail: bobgreaser@yahoo.com

Claim Number: 2BDH3

Policy Number: HEICP-250163

Type of Loss: Wind Damage

Date Contacted: 5/1/2024 5:37 PM

Date of Loss: 3/14/2024 6:31 PM

Date Received: 5/1/2024 6:32 PM

Date Inspected: 5/17/2024 6:32 PM

Date Entered: 5/17/2024 6:29 PM

Date Est. Completed: 7/15/2024 5:57 PM

Price List: OHCO8X_MAY24
Restoration/Service/Remodel

Estimate: 2BDH3_WINDCHES_BL5

This estimate of repair contains our repair recommendations, subject to review by the insurance company. No adjuster has authority to authorize repairs or guarantee payment.

Any person who knowingly and with intent to defraud any insurance company or another person, files a statement of claim containing any materially false information, or conceals for the purpose of misleading, information concerning any fact, material thereto, commits a fraudulent insurance act, which is a crime, subject to criminal prosecution.

T. Barrett & Associates
 Address: PO Box 5069
 Louisville, KY 40255
 Phone: 502.365.1462
 Fax: 502.290.2091
 Toll Free: 1-877-770-1113

2BDH3_WINDCHES_BL5
BLDG 5 - 6680-6708 Kodiak Drive
Roof

Roof 5

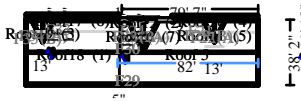

6437.13 Surface Area	64.37 Number of Squares
577.82 Total Perimeter Length	180.75 Total Ridge Length

DESCRIPTION

QTY

1. Remove Laminated - comp. shingle rfg. - w/out felt	64.37 SQ
2. Laminated - comp. shingle rfg. - w/out felt	71.00 SQ
3. Roofing felt - 15 lb.	47.14 SQ
4. Ice & water barrier	1550.03 SF
In valleys.	
5. R&R Valley metal - (W) profile - painted	108.59 LF
6. R&R Drip edge	577.82 LF
7. Asphalt starter - universal starter course	408.08 LF
8. Continuous ridge vent - shingle-over style	160.75 LF
9. Hip / Ridge cap - Standard profile - composition shingles	180.75 LF
10. Flashing - pipe jack	24.00 EA
11. Roof vent - turtle type - Metal	16.00 EA
12. Remove Additional charge for high roof (2 stories or greater)	54.40 SQ
13. Additional charge for high roof (2 stories or greater)	54.40 SQ
14. Remove Additional charge for steep roof - 7/12 to 9/12 slope	4.99 SQ
15. Additional charge for steep roof - 7/12 to 9/12 slope	4.99 SQ

NOTES:

T. Barrett & Associates
 Address: PO Box 5069
 Louisville, KY 40255
 Phone: 502.365.1462
 Fax: 502.290.2091
 Toll Free: 1-877-770-1113

Grand Total Areas:

384.00 SF Walls	144.00 SF Ceiling	528.00 SF Walls and Ceiling
144.00 SF Floor	16.00 SY Flooring	48.00 LF Floor Perimeter
0.00 SF Long Wall	0.00 SF Short Wall	48.00 LF Ceil. Perimeter
144.00 Floor Area	160.44 Total Area	384.00 Interior Wall Area
2,099.94 Exterior Wall Area	50.67 Exterior Perimeter of Walls	
6,437.13 Surface Area	64.37 Number of Squares	577.82 Total Perimeter Length
180.75 Total Ridge Length	0.00 Total Hip Length	

T. Barrett & Associates
Address: PO Box 5069
Louisville, KY 40255
Phone: 502.365.1462
Fax: 502.290.2091
Toll Free: 1-877-770-1113

Insured: Winchester Lake Apartments LLC
Property: 6659-6703 Buntline Drive
Canal Winchester, OH 43110

Business: (614) 317-1781

Claim Rep.: Bob Greaser
Company: T. Barrett and Associates

Business: (317) 522-6757
E-mail: bobgreaser@yahoo.com

Estimator: Bob Greaser
Company: T. Barrett and Associates

Business: (317) 522-6757
E-mail: bobgreaser@yahoo.com

Claim Number: 2BDH3

Policy Number: HEICP-250163

Type of Loss: Wind Damage

Date Contacted: 5/1/2024 8:20 AM

Date of Loss: 3/14/2024 6:31 PM

Date Received: 5/1/2024 6:32 PM

Date Inspected: 5/17/2024 6:32 PM

Date Entered: 5/17/2024 6:29 PM

Price List: OHCO8X_MAY24
Restoration/Service/Remodel

Estimate: 2BDH3_WIND_LAKE-B4

This estimate of repair contains our repair recommendations, subject to review by the insurance company. No adjuster has authority to authorize repairs or guarantee payment.

Any person who knowingly and with intent to defraud any insurance company or another person, files a statement of claim containing any materially false information, or conceals for the purpose of misleading, information concerning any fact, material thereto, commits a fraudulent insurance act, which is a crime, subject to criminal prosecution.

T. Barrett & Associates
 Address: PO Box 5069
 Louisville, KY 40255
 Phone: 502.365.1462
 Fax: 502.290.2091
 Toll Free: 1-877-770-1113

2BDH3_WIND_LAKE-B4
BLDG 20 6655 Kodiak Drive
Exterior

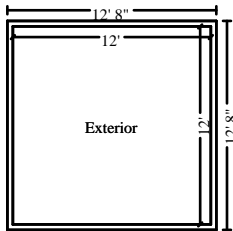

Exterior

Height: 8'

384.00 SF Walls	144.00 SF Ceiling
528.00 SF Walls & Ceiling	144.00 SF Floor
16.00 SY Flooring	48.00 LF Floor Perimeter
48.00 LF Ceil. Perimeter	

DESCRIPTION

QTY

1. Soffit - metal/vinyl - Detach & reset	10.00 SF
2. Siding - Labor Minimum	1.00 EA
3. R&R Fascia - metal - 8"	10.00 LF

NOTES:

Roof

Roof 4

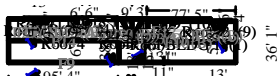

8896.09 Surface Area	88.96 Number of Squares
767.37 Total Perimeter Length	276.04 Total Ridge Length

DESCRIPTION

QTY

4. Remove Laminated - comp. shingle rfg. - w/out felt	88.96 SQ
5. Laminated - comp. shingle rfg. - w/out felt	98.00 SQ
6. Roofing felt - 15 lb.	67.58 SQ

T. Barrett & Associates
 Address: PO Box 5069
 Louisville, KY 40255
 Phone: 502.365.1462
 Fax: 502.290.2091
 Toll Free: 1-877-770-1113

CONTINUED - Roof 4

DESCRIPTION	QTY
7. Ice & water barrier In valleys.	2138.36 SF
8. R&R Valley metal - (W) profile - painted	188.20 LF
9. R&R Drip edge	767.37 LF
10. Asphalt starter - universal starter course	524.58 LF
11. Continuous ridge vent - shingle-over style	220.00 LF
12. Hip / Ridge cap - Standard profile - composition shingles	276.04 LF
13. Flashing - pipe jack	36.00 EA
14. Roof vent - turtle type - Metal	24.00 EA
15. Remove Additional charge for high roof (2 stories or greater)	77.17 SQ
16. Additional charge for high roof (2 stories or greater)	77.17 SQ
17. Remove Additional charge for steep roof - 10/12 - 12/12 slope	8.51 SQ
18. Additional charge for steep roof - 10/12 - 12/12 slope	8.51 SQ

NOTES:

Grand Total Areas:

384.00 SF Walls	144.00 SF Ceiling	528.00 SF Walls and Ceiling
144.00 SF Floor	16.00 SY Flooring	48.00 LF Floor Perimeter
0.00 SF Long Wall	0.00 SF Short Wall	48.00 LF Ceil. Perimeter
144.00 Floor Area	160.44 Total Area	384.00 Interior Wall Area
2,765.56 Exterior Wall Area	50.67 Exterior Perimeter of Walls	
8,896.09 Surface Area	88.96 Number of Squares	767.37 Total Perimeter Length
276.04 Total Ridge Length	0.00 Total Hip Length	

T. Barrett & Associates
Address: PO Box 5069
Louisville, KY 40255
Phone: 502.365.1462
Fax: 502.290.2091
Toll Free: 1-877-770-1113

Insured: Winchester Lake Apartments LLC
Property: 6636-6672 Kodiak Drive
Canal Winchester, OH 43110

Business: (614) 317-1781

Claim Rep.: Bob Greaser
Company: T. Barrett and Associates

Business: (317) 522-6757
E-mail: bobgreaser@yahoo.com

Estimator: Bob Greaser
Company: T. Barrett and Associates

Business: (317) 522-6757
E-mail: bobgreaser@yahoo.com

Claim Number: 2BDH3

Policy Number: HEICP-250163

Type of Loss: Wind Damage

Date Contacted: 5/1/2024 9:49 PM

Date of Loss: 3/14/2024 6:31 PM

Date Received: 5/1/2024 6:32 PM

Date Inspected: 5/17/2024 6:32 PM

Date Entered: 5/17/2024 6:29 PM

Date Est. Completed: 7/15/2024 10:39 PM

Price List: OHCO8X_MAY24
Restoration/Service/Remodel

Estimate: 2BDH3_WIND_LAKE-B3

This estimate of repair contains our repair recommendations, subject to review by the insurance company. No adjuster has authority to authorize repairs or guarantee payment.

Any person who knowingly and with intent to defraud any insurance company or another person, files a statement of claim containing any materially false information, or conceals for the purpose of misleading, information concerning any fact, material thereto, commits a fraudulent insurance act, which is a crime, subject to criminal prosecution.

T. Barrett & Associates
 Address: PO Box 5069
 Louisville, KY 40255
 Phone: 502.365.1462
 Fax: 502.290.2091
 Toll Free: 1-877-770-1113

2BDH3_WIND_LAKE-B3

BLDG 3 - 6636 Kokiak

Exterior

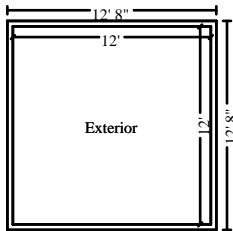

Exterior

Height: 8'

384.00 SF Walls	144.00 SF Ceiling
528.00 SF Walls & Ceiling	144.00 SF Floor
16.00 SY Flooring	48.00 LF Floor Perimeter
48.00 LF Ceil. Perimeter	

DESCRIPTION

QTY

1. Gutter - Labor Minimum	1.00 EA
---------------------------	---------

NOTES:

Roof



Roof 3

8896.09 Surface Area	88.96 Number of Squares
767.37 Total Perimeter Length	276.04 Total Ridge Length

DESCRIPTION

QTY

2. Roofing - Labor Minimum	1.00 EA
----------------------------	---------

T. Barrett & Associates
 Address: PO Box 5069
 Louisville, KY 40255
 Phone: 502.365.1462
 Fax: 502.290.2091
 Toll Free: 1-877-770-1113

CONTINUED - Roof 3

DESCRIPTION

QTY

NOTES:

Grand Total Areas:

384.00 SF Walls	144.00 SF Ceiling	528.00 SF Walls and Ceiling
144.00 SF Floor	16.00 SY Flooring	48.00 LF Floor Perimeter
0.00 SF Long Wall	0.00 SF Short Wall	48.00 LF Ceil. Perimeter
144.00 Floor Area	160.44 Total Area	384.00 Interior Wall Area
2,765.56 Exterior Wall Area	50.67 Exterior Perimeter of Walls	
8,896.09 Surface Area	88.96 Number of Squares	767.37 Total Perimeter Length
276.04 Total Ridge Length	0.00 Total Hip Length	

T. Barrett & Associates
Address: PO Box 5069
Louisville, KY 40255
Phone: 502.365.1462
Fax: 502.290.2091
Toll Free: 1-877-770-1113

Insured: Winchester Lake Apartments LLC
Property: 5637-5665 Xebec Drive
Canal Winchester, OH 43110

Business: (614) 317-1781

Claim Rep.: Bob Greaser
Company: T. Barrett and Associates

Business: (317) 522-6757
E-mail: bobgreaser@yahoo.com

Estimator: Bob Greaser
Company: T. Barrett and Associates

Business: (317) 522-6757
E-mail: bobgreaser@yahoo.com

Claim Number: 2BDH3

Policy Number: HEICP-250163

Type of Loss: Wind Damage

Date Contacted: 5/1/2024 11:07 PM

Date of Loss: 3/14/2024 6:31 PM

Date Inspected: 5/17/2024 6:32 PM

Date Received: 5/1/2024 6:32 PM

Date Entered: 5/17/2024 6:29 PM

Price List: OHCO8X_MAY24
Restoration/Service/Remodel
Estimate: 2BDH3_WIND_LAKE-BL2

This estimate of repair contains our repair recommendations, subject to review by the insurance company. No adjuster has authority to authorize repairs or guarantee payment.

Any person who knowingly and with intent to defraud any insurance company or another person, files a statement of claim containing any materially false information, or conceals for the purpose of misleading, information concerning any fact, material thereto, commits a fraudulent insurance act, which is a crime, subject to criminal prosecution.

T. Barrett & Associates
 Address: PO Box 5069
 Louisville, KY 40255
 Phone: 502.365.1462
 Fax: 502.290.2091
 Toll Free: 1-877-770-1113

CONTINUED - Roof 2

DESCRIPTION	QTY
7. Ice & water barrier In valleys.	1550.03 SF
8. R&R Valley metal - (W) profile - painted	108.59 LF
9. R&R Drip edge	575.81 LF
10. Asphalt starter - universal starter course	408.08 LF
11. Continuous ridge vent - shingle-over style	160.75 LF
12. Hip / Ridge cap - Standard profile - composition shingles	180.75 LF
13. Flashing - pipe jack	24.00 EA
14. Roof vent - turtle type - Metal	16.00 EA
15. Remove Additional charge for high roof (2 stories or greater)	54.40 SQ
16. Additional charge for high roof (2 stories or greater)	54.40 SQ
17. Remove Additional charge for steep roof - 7/12 to 9/12 slope	4.99 SQ
18. Additional charge for steep roof - 7/12 to 9/12 slope	4.99 SQ

NOTES:

Grand Total Areas:

384.00 SF Walls	144.00 SF Ceiling	528.00 SF Walls and Ceiling
144.00 SF Floor	16.00 SY Flooring	48.00 LF Floor Perimeter
0.00 SF Long Wall	0.00 SF Short Wall	48.00 LF Ceil. Perimeter
144.00 Floor Area	160.44 Total Area	384.00 Interior Wall Area
2,127.29 Exterior Wall Area	50.67 Exterior Perimeter of Walls	
6,437.13 Surface Area	64.37 Number of Squares	575.81 Total Perimeter Length
180.75 Total Ridge Length	0.00 Total Hip Length	